



Probe Ball Valve

For quick and easy installation and removal of the SS 20.600 flow sensor in pipe systems - without pressure cut-off



- Quick installation and removal of the SS 20.600 flow sensor in pipe system
- Installation and removal of the SS 20.600 flow sensor possible under pressure



Probe Ball Valve

For quick and easy installation and removal of the SS 20.600 flow sensor in pipe systems - without pressure cut-off

Ideal flow measurement in pipe systems

If you are planning compressed air networks, suitable measuring points for flow measurement must also be defined. Installing measuring points afterwards is time-consuming and expensive - especially since the pressure has to be switched off and the system "stands". The sensor ball valves are an ideal solution. They complement the SS 20.600 flow sensor in chamber head technology and can be installed at various points in the compressed air network. This makes measurement planning very easy, flexible and inexpensive. Which of these measuring points will be used later depends on the connected consumers. The sensor ball valves are constructed in such a way that the sensor can be installed and removed very quickly into the pipe even when pressure is applied.

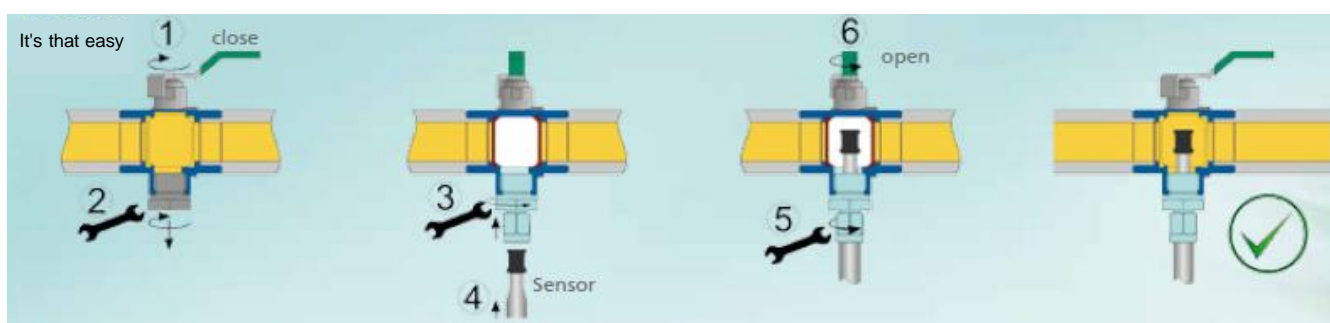

Technical data	
Temperature range	-20 ... +120°C
Compressive strength	PN 20/32/40 (DG-probe ball valve)
Pipe connection (probe ball valve)	1"; 1¼"; 1½"; 2" IG
Connection sensor	Inner thread G ½"
Material housing	Brass nickel plated
Material bullet	brass; hard chrome plated
Material seals	PTFE
Medium	Air; not aggressive gases
Weight probe ball valve	500/900/1.250/1.800 g
Weight passage ball valve	300 g
For larger pipe diameters from DN 65, it is recommended to use a straight-way ball valve with a welding nipple. The SS 20.600 flow sensor is inserted into the pipe through the straight-through ball valve.	

D-EN-Probe-ball-valve-20200129



Probe Ball Valve

For quick and easy installation and removal of the SS 20.600 flow sensor in pipe systems - without pressure cut-off

Ordering information probe ball valve and passage ball valve	
Description	Art. No.
Sensor ball valve 1" internal thread, PN 32 connection Flow sensor: 1/2" internal thread, including plug and chain	530 940
Sensor ball valve 1 1/4" internal thread, PN 20 connection Flow sensor: 1/2" internal thread, including plug and chain	530 941
Sensor ball valve 1 1/2" internal thread, PN 20 connection Flow sensor: 1/2" internal thread, including plug and chain	530 942
Sensor ball valve 2" internal thread, PN 20 connection Flow sensor: 1/2" internal thread, including plug and chain	530 943
Passage ball valve 3/4" internal thread, PN 40 connection With thread adapter on 1/2" through screw connection	532 355
Welding nipple, steel, external thread 3/4", 5 pieces	531 200
Welding nipple, steel, external thread 3/4", 2 pieces	531 201

D-EN-Probe-ball-valve-20200129

Important instructions!

Technical changes and errors reserved.

Pictures can be similar.

The operating instructions belonging to this device must be observed! Download at www.schmidt-messtechnik.com.